

MAYOR DANIEL J. REIMAN  
& CARTERET BOROUGH COUNCIL PRESENT

A GUIDE TO THE  
CARTERET  
PARK SYSTEM







## BOROUGH OF CARTERET

**Daniel J. Reiman, Mayor**

Dear Neighbor:

Carteret has become a regional destination in Central Jersey for the arts, our quick paths to New York City, including the upcoming Ferry Terminal, and our vast array of public recreational amenities.

Residents and visitors are continually rediscovering Carteret's potential, while our quality of life standards are shaping the quaint livability that is Carteret.

With more than \$250 million invested in our parks system alone, Carteret now proudly boasts a range of public recreational facilities that includes our Waterfront Park – 17 acres of picturesque open space hosting our new Municipal Marina, upcoming Ferry Terminal, nearly 2 miles of public Riverwalk, our popular fishing pier, boat launch, and passive and active recreational amenities, including miniature golf, a putting green, walkways, bike paths, and a sensory perception garden.

With 11 additional parks, including the newly dedicated Mayor James A. Failace Memorial Park, formerly Shorecrest Park, and Sgt. Jack McGreevey Memorial Park, formerly Cornell Estates Park, showcased in this quiet community, offering a range of state-of-the-art sports facilities, and natural landscapes, plus our 36,000-square-foot health and wellness center, Carteret has become a welcome home to both fitness and relaxation, offering the perfect balance of work and pleasure to any resident.

Please take a moment to discover – or rediscover – our parks system, one of the many reasons why **Carteret is a great place to live, work, and raise a family.**

Thank you for your support as we continue building a better Carteret!

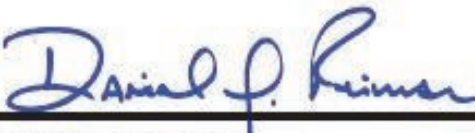

Sincerely,

  
**Daniel J. Reiman**  
*Mayor, Borough of Carteret*



# Table of Contents

- 2 Letter from the Mayor**
- 4 Carteret Park**
- 5 Waterfront Park**
- 6 Civic Center Park**
- 7 Medwick Park**
- 8 Coming Soon to Carteret Parks**
- 9 Adopt A Park**
- 10 Bishop Andrews Park**
- 11 Noe Street Park**
- 12 Sgt. Jack McGreevey Memorial Park**
- 13 Mayor James A. Failace Memorial Park**
- 14 Ash Street Park / John Street Park**
- 15 Grant Park / Banick Park**
- 16 Park Map**

*Cover photo by Frank F. Rosario (frankfrosario.com)*



# CARTERET PARK

CARTERET AVE & CYPRESS STREET



- Basketball Courts
- Tennis Courts
- Baseball Fields
- Carteret Pond (Fishing Permitted)
- Playground
- Sprayground
- Bandstand
- 9/11 Memorial
- Soldiers & Sailors Memorial



*The 9/11 Memorial at Carteret Park*



# **WATERFRONT PARK**

## **200 MIDDLESEX AVENUE**



- **Ferry Terminal**  
(Under Construction)
- **Fishing Pier**
- **Riverwalk**
- **Marina**
- **Playground**
- **Miniature Golf**
- **Concessions**

- **Restrooms**
- **Bocce Pit**
- **Shuffleboard**
- **Horseshoe Pit**
- **Volleyball Nets**
- **Picnic Area**
- **Gazebo/Bandstand**



# CIVIC CENTER PARK

## PERSHING AVE & COOKE AVE



- **Baseball Fields \***
- **Softball Field \***
- **Football Field**
- **Multi-Purpose Field**
- **Skate Park**
- **Dog Park**

*\* New turf just installed at Veterans Baseball Field & Mustillo Softball Field!*





# MEDWICK PARK

# POST BOULEVARD/PAULINE STREET

**OPERATED BY MIDDLESEX COUNTY**



- **Baseball Fields**
- **Softball Fields**
- **Football Fields**
- **Multi-Use Fields**
- **Tennis Courts**
- **Playgrounds**
- **Shared-Use Paths**

- **Observation Deck**
- **Comfort Stations**
- **Walking Paths**





# Coming Soon to Carteret Parks!

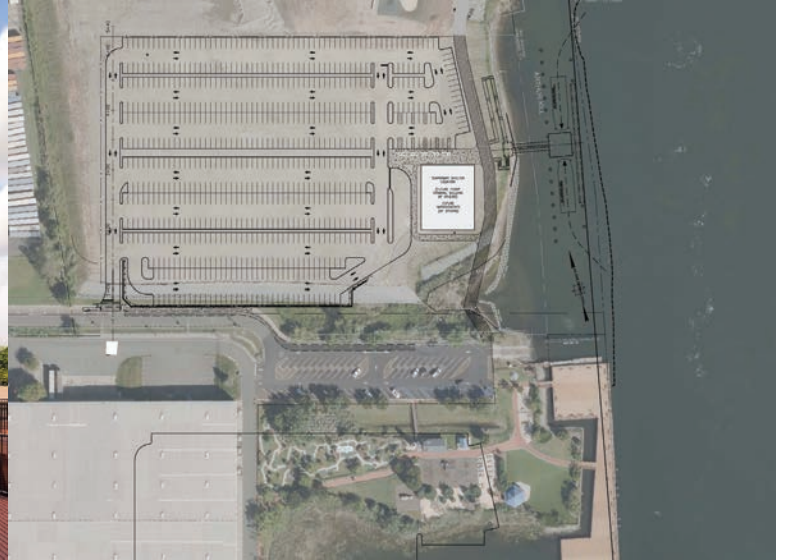

Improvements coming to Carteret Parks include, clockwise from left, to Waterfront Park, a restaurant pavilion, ferry terminal parking lot, Southern Riverwalk, and Northern Riverwalk; to Mayor James A. Failace Memorial Park, two pickleball courts, and to Carteret Park, resurfaced tennis and basketball courts.





# **CARTERET ADOPT A PARK FALL CLEANUP**



**Saturday, Oct. 21  
10 a.m. to 12 p.m.**



**Help Volunteers Who Have Adopted  
Carteret & Bishop Andrews Parks  
Clean Them Up  
Or Adopt One of Our Other Parks  
and Help Clean It Up**

**For more information,  
contact the Clean Communities Office at  
732-541-3835 or [makinb@carteret.net](mailto:makinb@carteret.net)**



**BISHOP WILARD K. ANDREWS**

# **CHROME PARK**

**PERSHING AVENUE & SALEM AVENUE**



- **Baseball Fields**
- **Football/Lacrosse/  
Soccer/Softball Field**
- **Volleyball Courts**
- **Playground**
- **Spray Park**
- **Fitness Stations**
- **Gazebo**

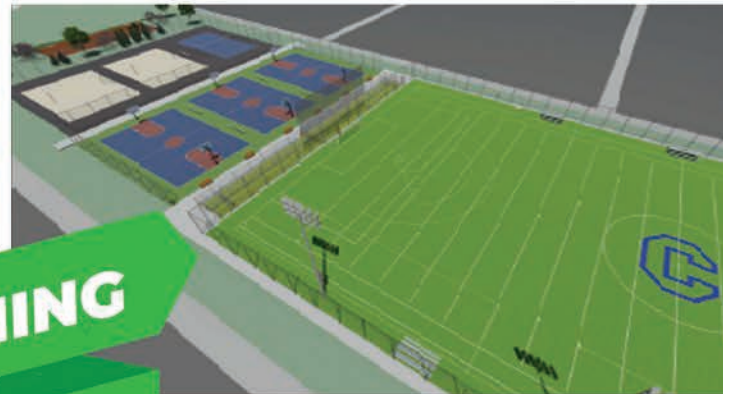
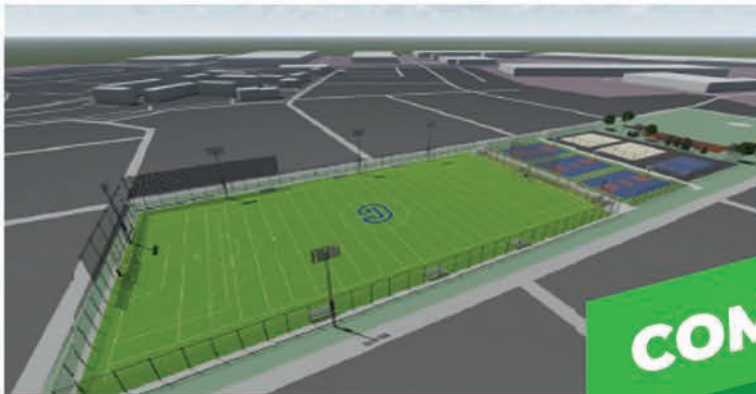

**COMING**

**SOON**





# NOE STREET PARK

## NOE STREET & PERSHING AVENUE



- **Gazebo**
- **Walking Path**
- **Fitness Stations**
- **Fountain**
- **Ice Skating**  
(only when posted)





# SGT. JACK MCGREEVEY MEMORIAL PARK

ORCHARD STREET & PINHO STREET





# MAYOR JAMES A. FAILACE MEMORIAL PARK

SYCAMORE STREET & SUMUTKA AVE

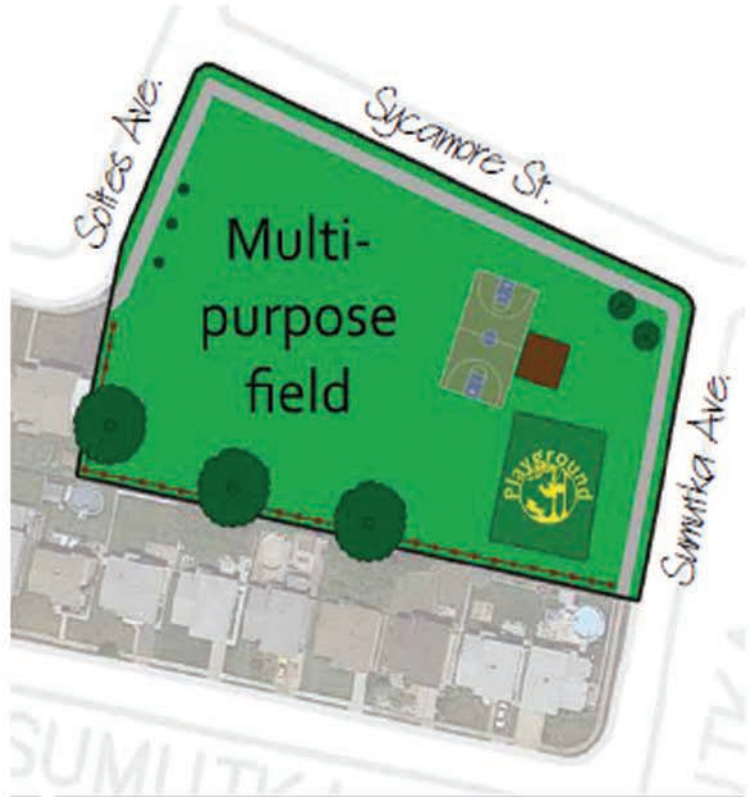



# ASH STREET PARK

ASH STREET & ARTHUR AVENUE



# JOHN ST. SOCCER PARK

BEVERLY STREET & LEFFERT STREET





# GRANT AVE PARK

## GRANT AVENUE & HAYWARD AVENUE

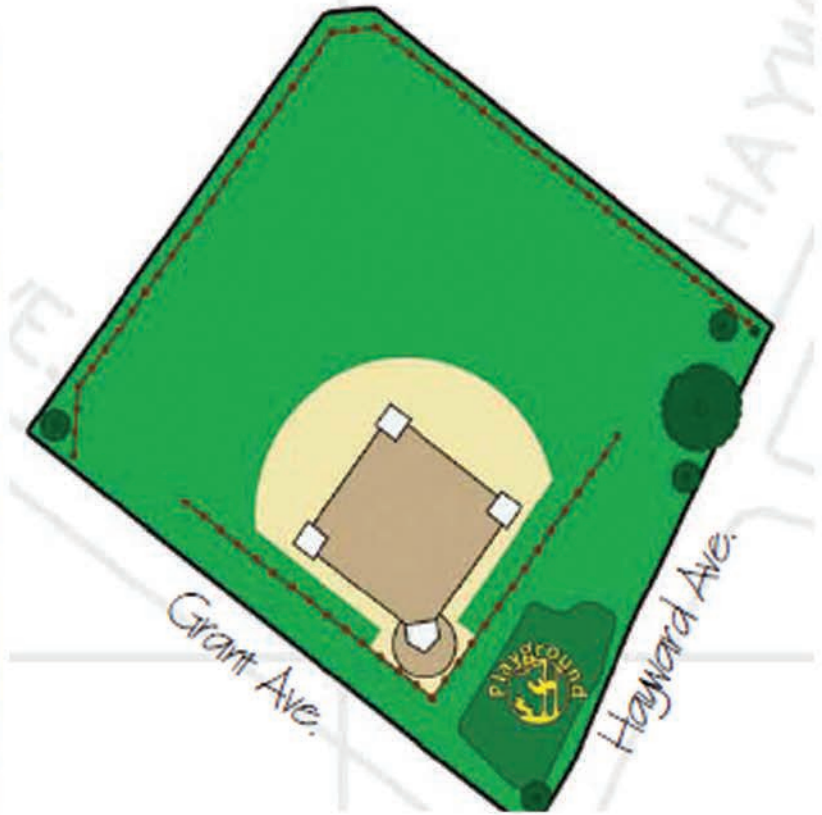

# BANICK PARK

## ROOSEVELT AVE & HERBERT AVENUE





The Carteret Business Partnership, Inc.  
Memorial Municipal Building  
61 Cooke Avenue  
Carteret, NJ 07008

ECRWSS  
RESIDENTIAL CUSTOMER

NONPROFIT ORGANIZATION  
U.S. POSTAGE  
PAID  
Rahway, NJ  
Permit No. 83

# CARTERET PARKS

